



Design Elements for a Methow Valley Community Garden

Cooper Castelle, Wren Grojean, Olivia Kaulfus, Sage Martin



Grocery List:

Problem Statement

Our Goals

Methodology

Results

Recommendations

Final Thoughts

Q&A time

Problem Statement



Methow Valley permanent residents are concerned about food sovereignty despite being surrounded by agricultural lands.

Overwhelming wealth gap:

30% of children in the Methow live in poverty

Self-sufficiency standard income *more than double* poverty line

A minimum wage job does not cover the cost of basic needs for families

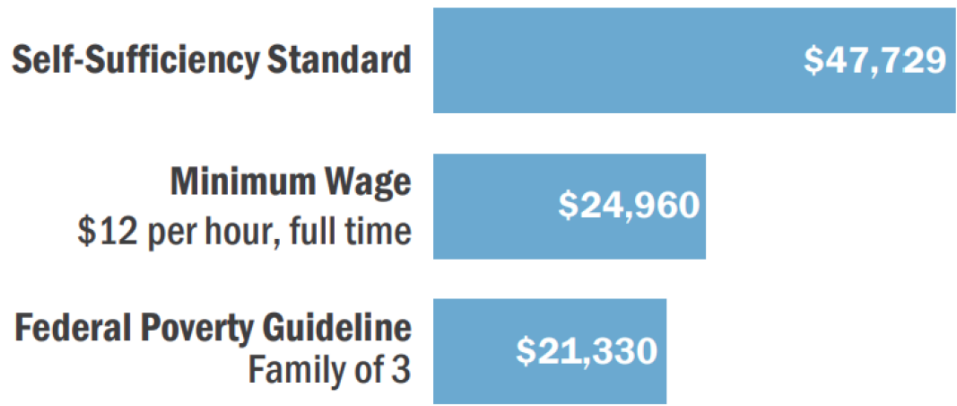

Methow Valley, WA 2019
1 adult + 1 preschooler + 1 school-age

Number of hours a minimum wage worker must work per week to meet her family's basic needs

75

Our Goals/ Objectives



1. Research various community garden models in order to suggest an organizational structure for a hypothetical community garden project
1. Collect information on physical infrastructure
1. Identify possible funding sources
1. Research pros and cons of a community garden in the Methow Valley, and provide recommendations.

Methodology

Benchmarking other community gardens

Researching specific benefits of community gardens related to the needs we intend to address

Researching physical design elements of community gardens such as fencing, water and soil health.

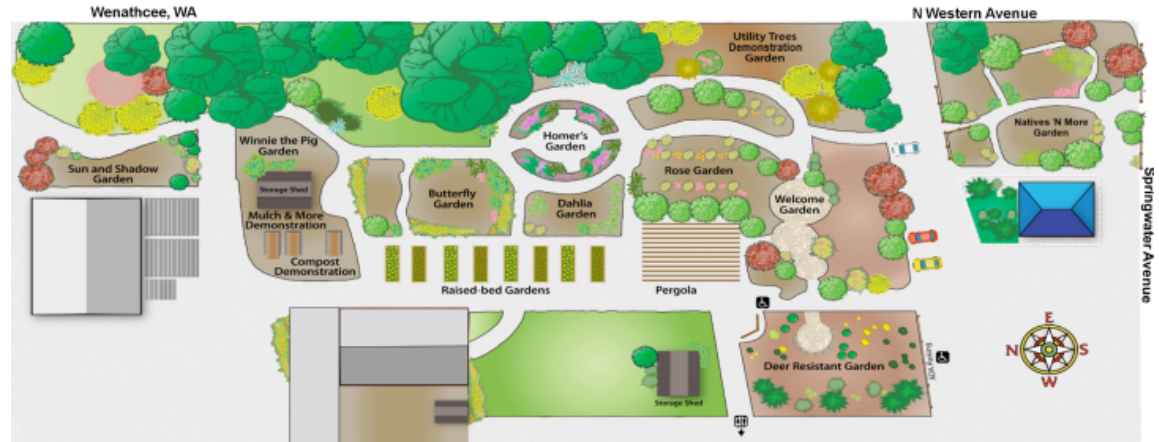



Benchmarking

1. Population Density
2. Land Ownership
3. Staff
4. Size
5. Plot Types, Sizes, and Prices
6. Other Uses & Fun Facts
7. Budget/ Funding

Benchmarking



Population Density: Majority Urban

Land Ownership: True ownership, nonprofits, parks department, leased land

Staff Structure: Majority volunteers

- Some had non-profit staff or parks department

Size: Ranged from 14.5 acres to $\frac{1}{4}$ acre

- Rural garden benchmarked was $<\frac{1}{2}$ acre

Benchmarking



Plot Types: Majority Individual plots

- Some mixed with communal/donation plots

Plot Sizes: Range: 4'x8' to 10'x40'

- Majority smaller than 10'x10'

Plot Prices: Range: \$10 to \$55

- Based on target audience, size of plot, size of garden

Other Uses & Fun Facts: Education programs and classes

- Organic-only, TLC programs

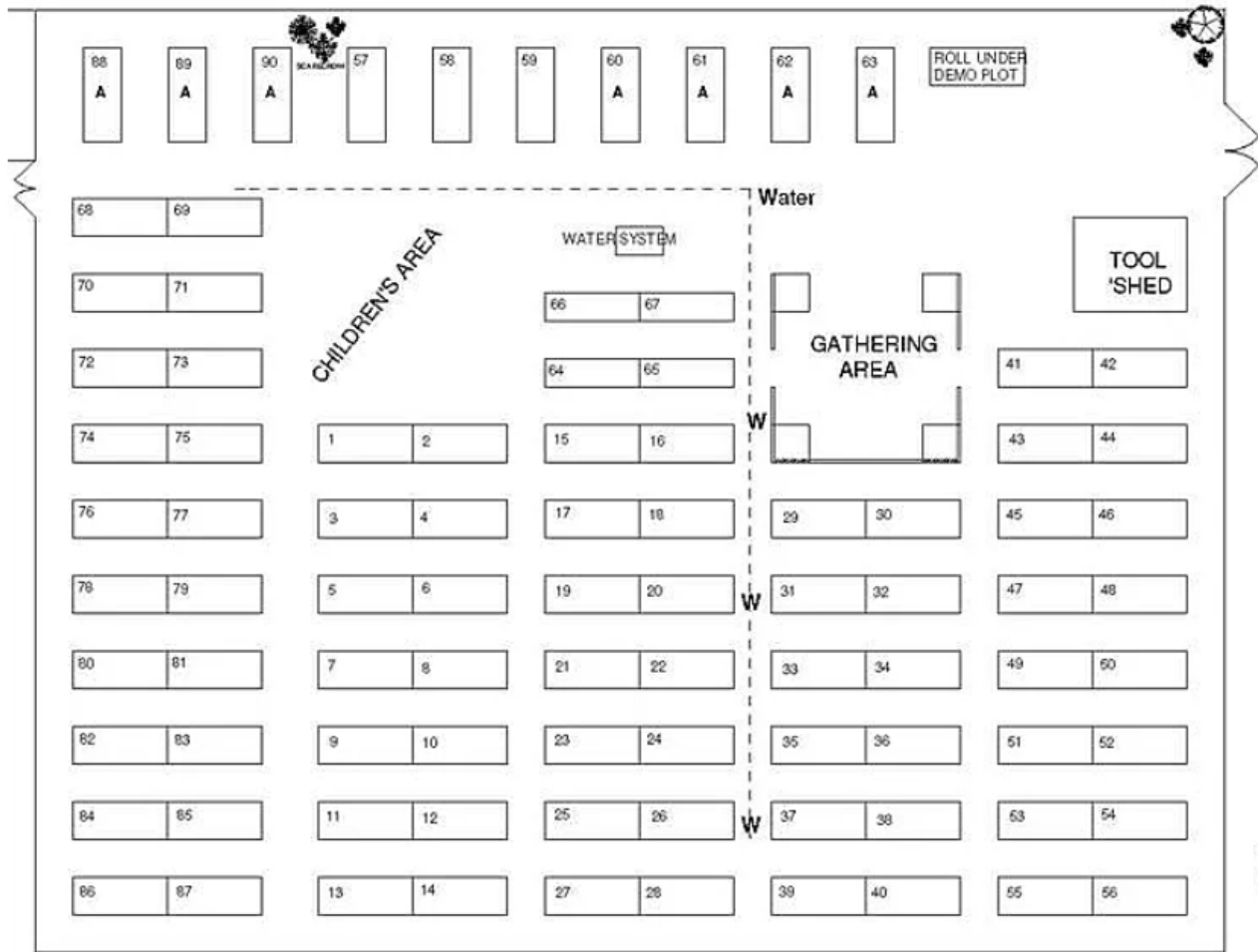

Budget

Start-up expenses:

- Land Acquisition
- Construction
 - Shed, Raised Beds, Compost pile, Irrigation
- Tools
- Site preparation

Start-up funding:

- Donations (money or supplies)
- Grants
 - Rural Community Assistance Corp



Budget

Annual budget:

- Main Expense: **Water Bill**
 - *Repairs, Tools, Property taxes/leasing*
- Main Revenue: **Plot rentals**
 - *Classes & events, Donations, Parks Dept*



Benefits of Community Gardens



Food security → food sovereignty

Community development

Food education

Improves mental health

ADHD, Depression, Anxiety

Drug rehab, addiction and relapse
prevention

Improves Physical health

And encourages a healthier diet

Benefits of Community Gardens



Garden food has 3-5 times more nutritious than store bought!

Combats poor air quality & heat islands

Rest for native fauna

Hyper-local moisture & cool air

Utilizes polyculture

Safely combats the negative effects of the agriculture industry



SUSTAINABLE DEVELOPMENT GOALS

1 NO POVERTY

2 ZERO HUNGER

3 GOOD HEALTH AND WELL-BEING

4 QUALITY EDUCATION

5 GENDER EQUALITY

6 CLEAN WATER AND SANITATION

7 AFFORDABLE AND CLEAN ENERGY

8 DECENT WORK AND ECONOMIC GROWTH

9 INDUSTRY, INNOVATION AND INFRASTRUCTURE

10 REDUCED INEQUALITIES

11 SUSTAINABLE CITIES AND COMMUNITIES

12 RESPONSIBLE CONSUMPTION AND PRODUCTION

13 CLIMATE ACTION

14 LIFE BELOW WATER

15 LIFE ON LAND

16 PEACE, JUSTICE AND STRONG INSTITUTIONS

17 PARTNERSHIPS FOR THE GOALS

SUSTAINABLE DEVELOPMENT GOALS



Recommendations

1. *Strong volunteer program*
2. Small/vanity plots for beginners, diverse plot sizes
3. SHADE
4. Communal/Donation plots
5. Find multiple sources for initial funding
 - a. Grants, donations, sponsoring, fundraising events
6. Encourage active community involvement
 - a. Organize community events
 - b. Emphasize accessibility

Final Thoughts

If a garden was placed in the Methow Valley, it would be beneficial for:

- Food sovereignty and food security
- Rural community development
- Environmental and food education
- Mental health
 - Modern stressors, climate change
- Involvement with the arts



Thank you for listening!





Questions?